

Businessplan

Student cafe „Meeting“

Cafe, bar and lounge for students in Jülich

meeting
cafe

Description

meeting

cafe

Product description

- A new café in Jülich
 - by students → for students
 - Opening hours: 10.30am – 0.00am (Weekend open end)
- Why the concept is successful:
 - We have a lot of students in Jülich
 - There is no student café in Jülich
 - We offer a modern atmosphere, good prices and special events

meeting

cafe

Product description

- The name of the student café is “meeting”
- From morning to afternoon (café):
 - Meet with friends
 - Spend the break between the lecture
 - Eat some snacks like sandwiches or cake
 - Learn in a peaceful atmosphere (free Wi-Fi)

meeting

cafe

Product description

- In the evening (lounge):
 - Live music by DJ
 - Drink some cocktails
 - Meet with friends and talk about the day
- Special events:
 - International evenings
(with the standard local music and drinks)
 - Role your price (dice game)

meeting

cafe

Product description

- The “meeting” provides space for 47 people
- The location is central, it’s reachable by foot from the city and from the FH Aachen

meeting

cafe

Product description

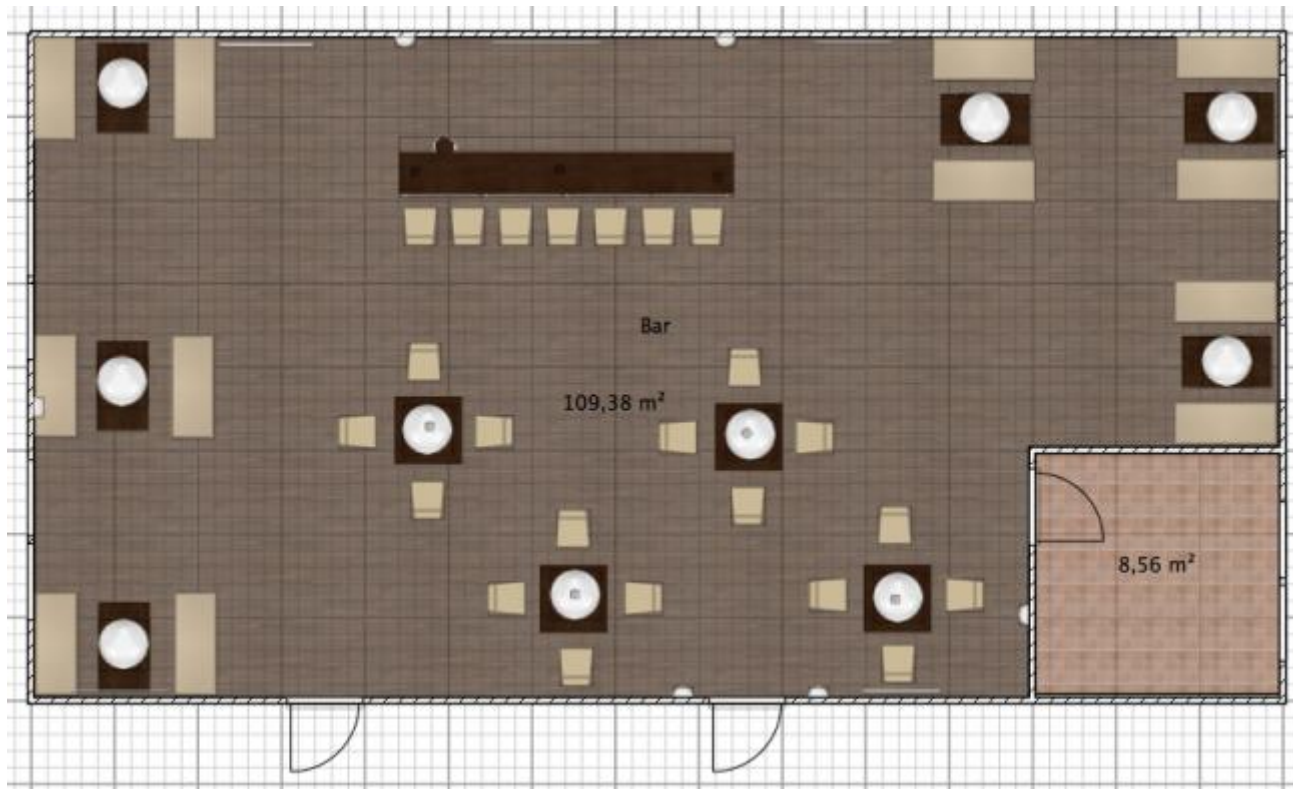

meeting
cafe

Product description



meeting
cafe

Product description



meeting
cafe

Market analysis

meeting

cafe

Market analysis

- We have:
 - 3407 students in Jülich
 - 876 students are living in Jülich (registered)
 - We estimate the number of students who are living in Jülich at 1000

(Information from the secretary's office)

meeting

cafe

Market analysis

- In Jülich we have 5 competitors:
 - Pub
 - Liebevoll
 - Careba
 - KuBa
 - Cortés

only competitors where you don't have to eat something
(in the most restaurants you are undesired if you don't want
to eat something e.g. an italian restaurant)

meeting

cafe

Market analysis

Pub

- Seats: 40-50
- Offer:
 - Local Irish drinks
 - Snacks
 - Table soccer
 - Soccer broadcast
 - Special events
(all you can eat,
whiskey tasting)
- Opening Hours:
 - 5 pm - 12 pm



meeting

cafe

Market analysis Liebevoll

- Seats: 50-60
- Offer:
 - Hotel
 - Restaurant
 - Special events (karaoke, live DJ, special eat offer)
- Opening Hours:
 - 11 am – 11 pm (1 am)



meeting
cafe

Market analysis

Careba

- Seats: 50
- Offer:
 - Restaurant
 - Cocktails
 - Sky broadcast
- Opening Hours:
 - 8 am - 1 am (3 am)



meeting

cafe

Market analysis KuBa

- Seats: 40
- Offer:
 - Special drink offers
 - Special parties
(black & white, 70er
80er 90er, students
party)
- Opening Hours:
 - Wed, Fri, Sat
 - 6 pm – 1 am (3 am)



meeting
cafe

Market analysis Cortés

- Seats: 60-70
- Offer:
 - Cocktails
 - Restaurant
- Opening Hours:
 - 10 am – 0 am (2 am)



meeting
cafe

Market analysis

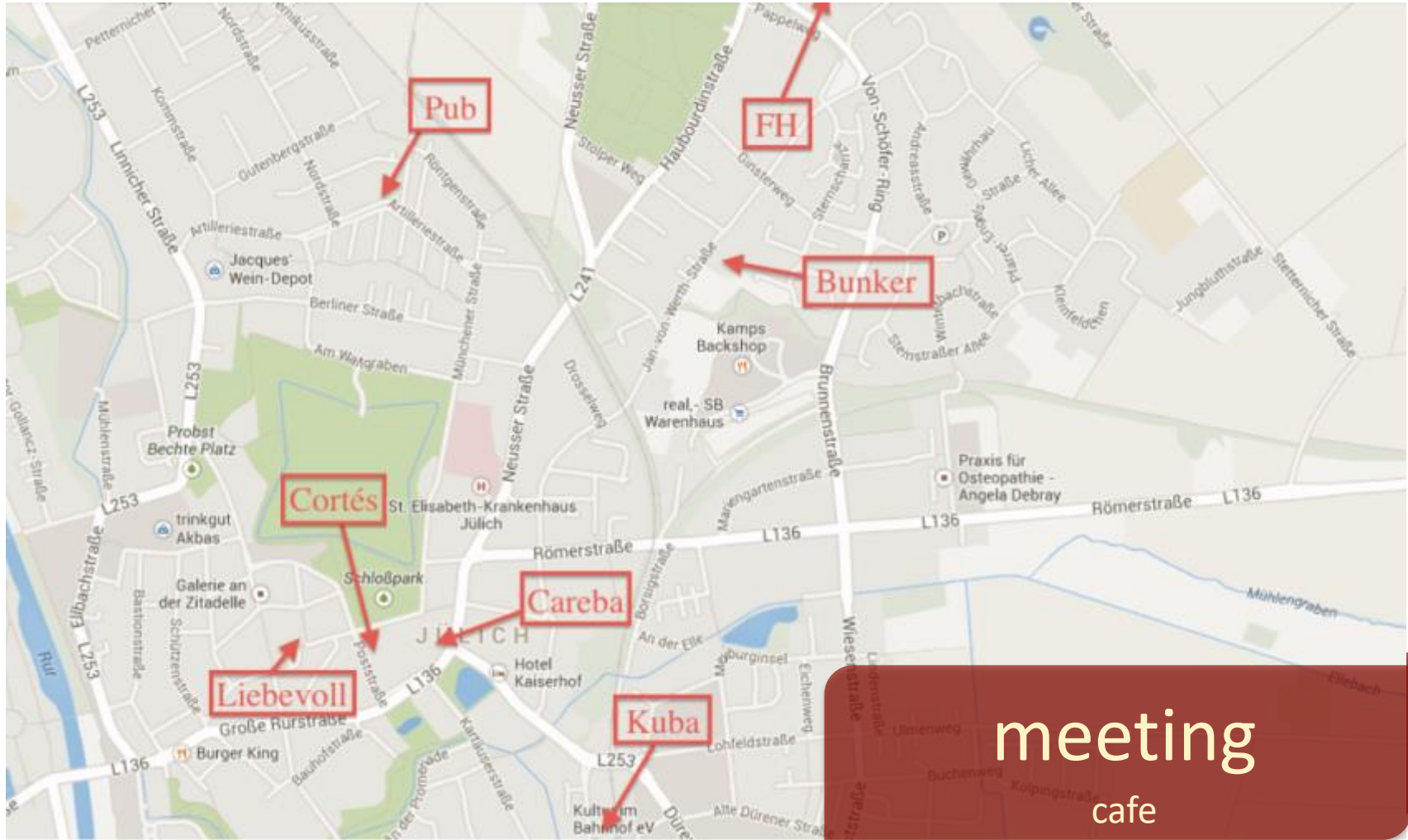

Calculations

meeting

cafe

Calculations

Invest cost

	Object	Quantity	Unit price	Total price	Afa	Depreciation
furniture	bar chairs	30	90 €	2.700 €	1	2.700 €
	bar tables	6	105 €	630 €	1	630 €
	tables	8	169 €	1.352 €	1	1.352 €
	benches	14	94 €	1.316 €	1	1.316 €
bar	fully automatic cafe mashine	1	8.290 €	8.290 €	5	1.658 €
	mixers	1	126 €	126 €	1	126 €
	shakers	3	12 €	36 €	1	36 €
room	pictures	5	100 €	500 €	1	500 €
	ceiling lamps	15	70 €	1.050 €	1	1.050 €
	sound system	1	3.000 €	3.000 €	4	750 €
	wall lamps	10	70 €	700 €	1	700 €
kitchen	dishwasher	1	1.000 €	1.000 €	5	200 €
	sink unit	1	300 €	300 €	5	60 €
	stove	1	1.000 €	1.000 €	5	200 €
	counter top	1	110 €	110 €	5	22 €
	fridge	1	1.200 €	1.200 €	5	240 €
supplies	dishes	100	19 €	1.900 €	1	1.900 €
	glasses	600	1 €	600 €	1	600 €
	decoration	16	12 €	192 €	1	192 €
	menu	60	5 €	300 €	1	300 €

26.302 €

meeting

cafe

Calculations Investment

Total Cost Objekts	26.302 €
Liquor License	1.500 €
Coution	3.570 €
	31.372 €

We dont need a credit:

- Every owner gives 15.000€ private money

Costs for "rent/additional costs/GEMA" = 20.540€

meeting

cafe

Calculations

Depreciation

- If the investment is below 400 € and is designed for individual use, it can be depreciated over one year.

Depreciation / year	1. year	2. year	3. year	4. year	5. year	year 6-10
€	14.532 €	3.130 €	3.130 €	3.130 €	2.380 €	-

meeting
cafe

Calculations

Supply Cost

Estimated guests:

- Year 1-2 = 80 guests
- Year 3-6 = 100 guests
- Year 7-10 = 120 guests

The number of guests increases due to the popularity and the growing number of students

Supplies per guest:

- 0,75 Coffee
- 0,25 food (snacks, cakes)
- 1 soft drink
- 0,5 cocktails
- 1,5 beer
- 0,25 liquor

meeting

cafe

Calculations

Supply Cost

	purchase price	selling price
Coffee	0,20 €	1,50 €
Foods (snacks cake)	0,50 €	1,30 €
Softdrink	0,40 €	1,50 €
Cocktails	1,00 €	5,00 €
Beer	0,80 €	1,80 €
Liqueur	0,20 €	1,50 €

This average price of the drinks and food results:

- Cost per guest: 2,43€
- Sells per guest: 8,53€

Supply costs per year:

Year 1-2 (80 guests) = 70.810€

Year 3-6 (100 guests) = 88.513€

Year 6-10 (120 guests) = 106.215€

meeting

cafe

Calculations

Personal Cost

	Personal		per month	tax	year 1-2	year 3-6	year 7-10
10	Waiter	7 €/h	400 €	30%	62.400 €	62.400 €	62.400 €
1	Cleaning lady	8 €/h	360 €	30%	5.616 €	5.616 €	5.616 €
1	Barman	10 €/h	1.600 €	25%		24.000 €	24.000 €
					68.016 €	92.016 €	92.016 €

- The first two years the owner makes the management and the service
- After the two first years, due to the increasing number of visitors, we provide an additional barman

meeting

cafe

Calculations

Cash Flow calculation

year	1	2	3	4	5	6	7 to 10
Sales volume	248.930 €	248.930 €	311.163 €	311.163 €	311.163 €	311.163 €	373.395 €
Depreciation	14.532 €	3.130 €	3.130 €	3.130 €	2.380 €	- €	- €
Rent/additional costs	20.540 €	20.540 €	20.540 €	20.540 €	20.540 €	20.540 €	20.540 €
Supply costs	70.810 €	70.810 €	88.513 €	88.513 €	88.513 €	88.513 €	106.215 €
Personal costs	68.016 €	68.016 €	92.016 €	92.016 €	92.016 €	92.016 €	92.016 €
Caution/Liquor licence	5.070 €	- €	- €	- €	- €	- €	- €
Return	69.962 €	86.434 €	106.964 €	106.964 €	107.714 €	110.094 €	154.624 €
Buisness Taxes	6.969 €	9.494 €	12.642 €	12.642 €	12.757 €	13.122 €	19.948 €
Cashflow	62.993 €	76.940 €	94.322 €	94.322 €	94.957 €	96.972 €	134.676 €

Business Tax: 3,5% of the return multiplied with the municipal collection rate (Jülich 438%) minus the allowance (24.500€)

meeting
cafe

Conclusion

meeting

cafe

Conclusion

- We are confident because it is the first student café in Jülich and the numbers of students are increasing
- Rapid growth in profit because most depreciation are only in the first year

meeting
cafe